

Szafa metalowa Kubin



www.kubin.pl

Instrukcja Składania



Dziękujemy za wybranie nazej rodzinnej firmy Kubin i cieszymy się, że nasza szafa będzie stała w Twoim domu lub firmie. Prosimy zapoznać się z instrukcją, żeby sprawnie ukończyć montaż.



Czas montażu: 60-90minut

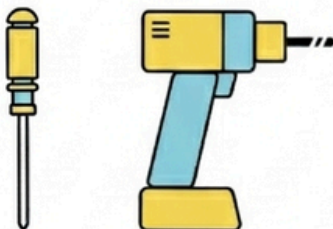

Narzędzia: wkrętarka lub
srubokręt

Użyj podkładki kartonowej na podłodze

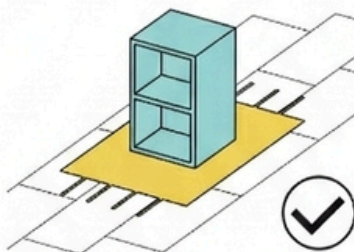
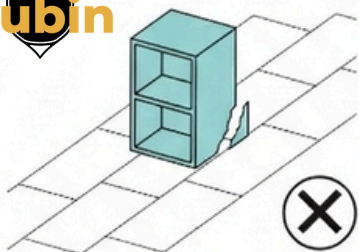

Wejdź na youtube
zeby zobaczyć film
instruktażowy do
składania szafy.

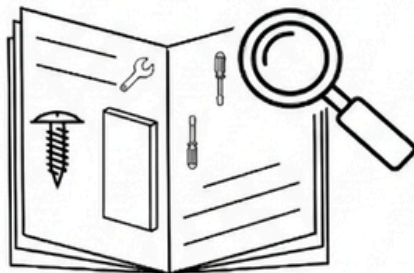

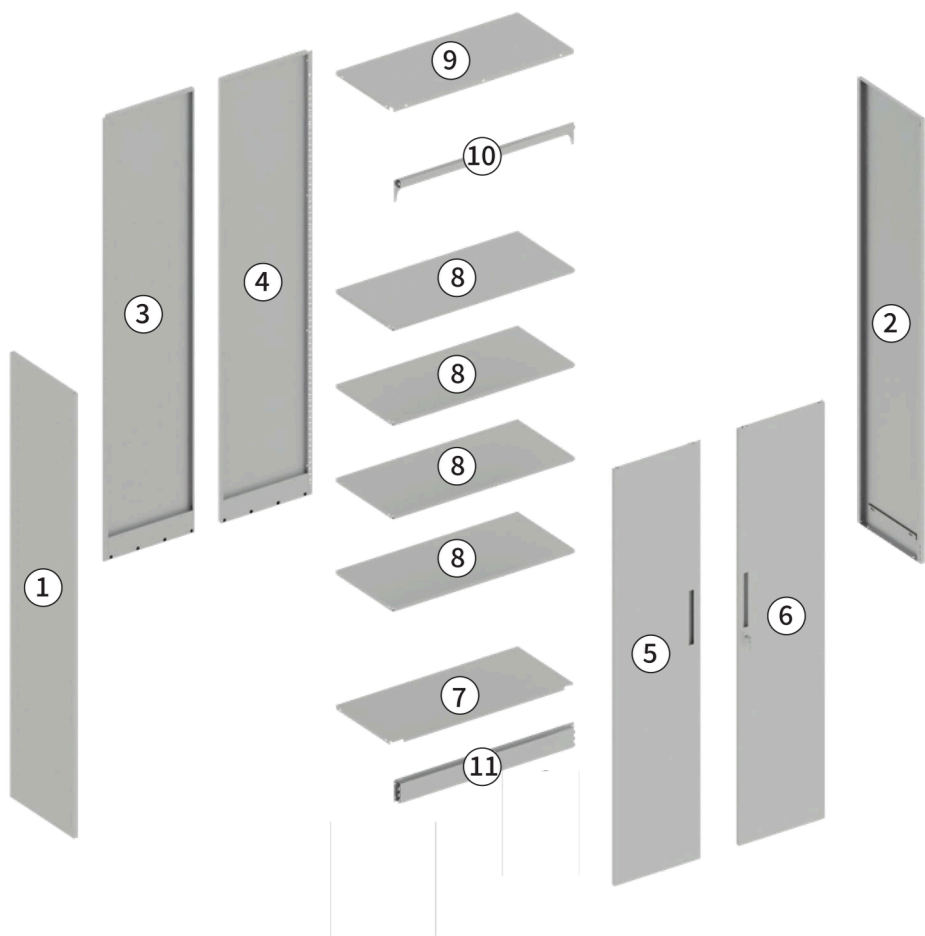

Kubin



①
1x **Lewa strona szafy**



②
1x **Prawa strona szafy**



③
1x **Panel tylny lewy**



④
1x **Panel tylny prawy**



⑤
1x **Drzwi lewe**



⑥
1x **Drzwi prawe**



7
1x Panel dolny



8
4x Półka



9
1x Panel górny



10
1x Belka górna

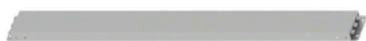

11
1x Belka dolna



L21
16x Klamra półki



C14
x4 Zawias



L19
2x Podkładka



K10
x Śruba

 Kubin

1



(K10)
4x

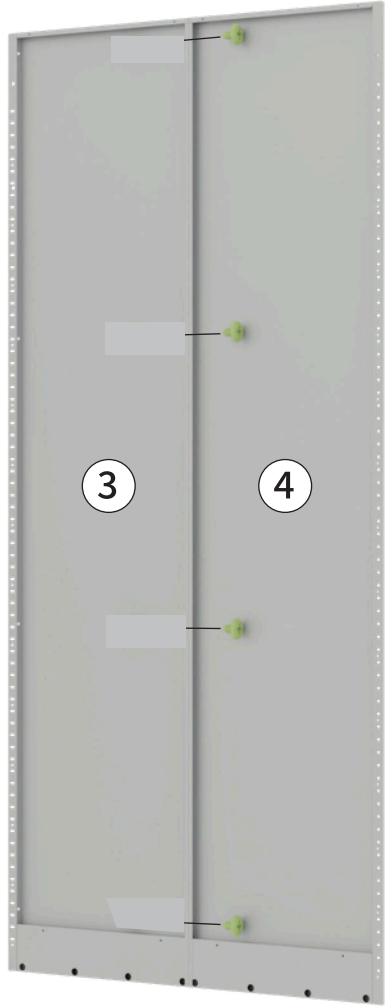
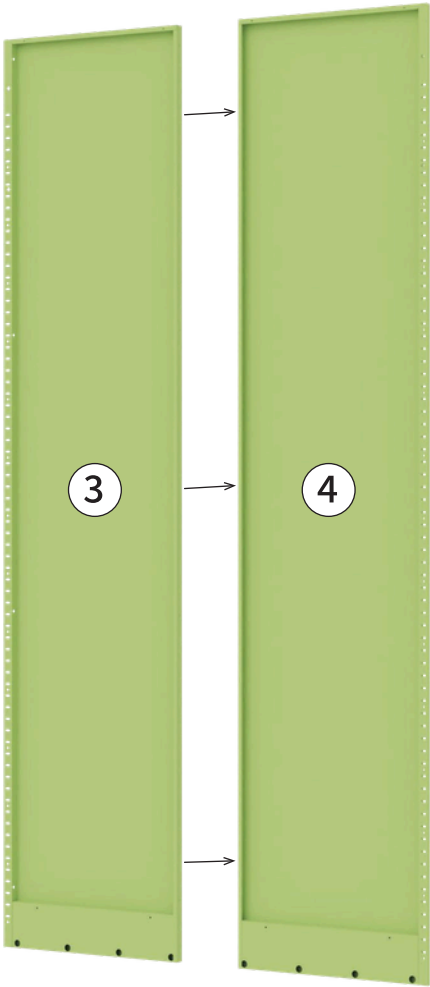

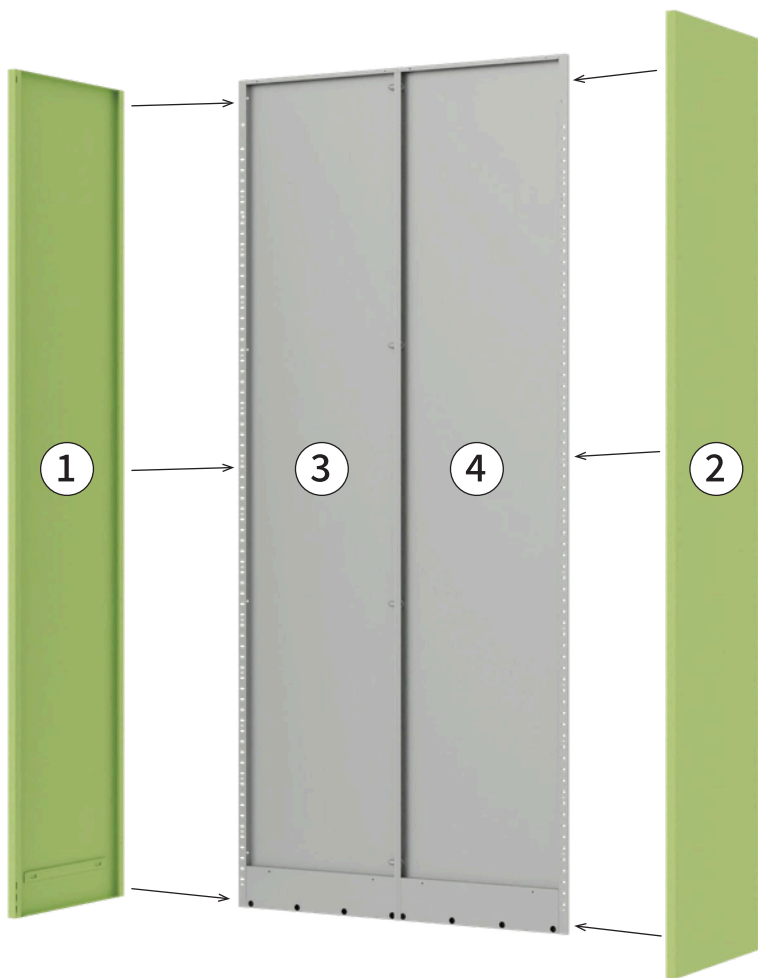

3



K10
8x



4



K10

4x

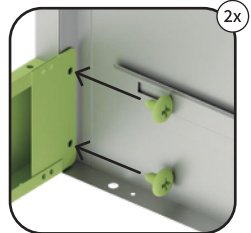
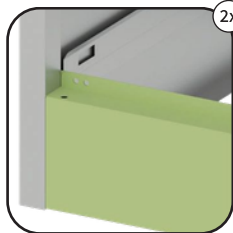
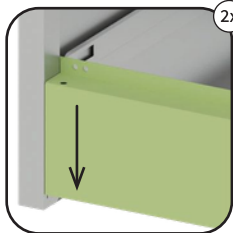
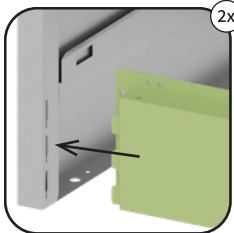

5



K10
4x

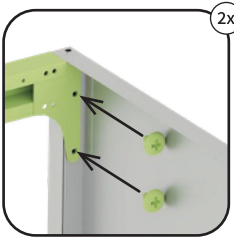
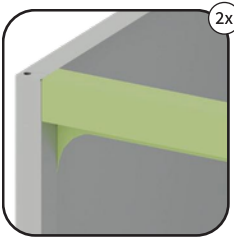
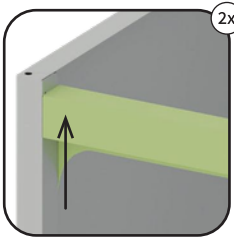
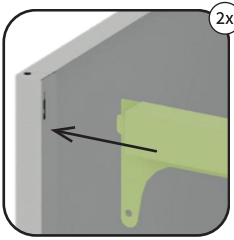

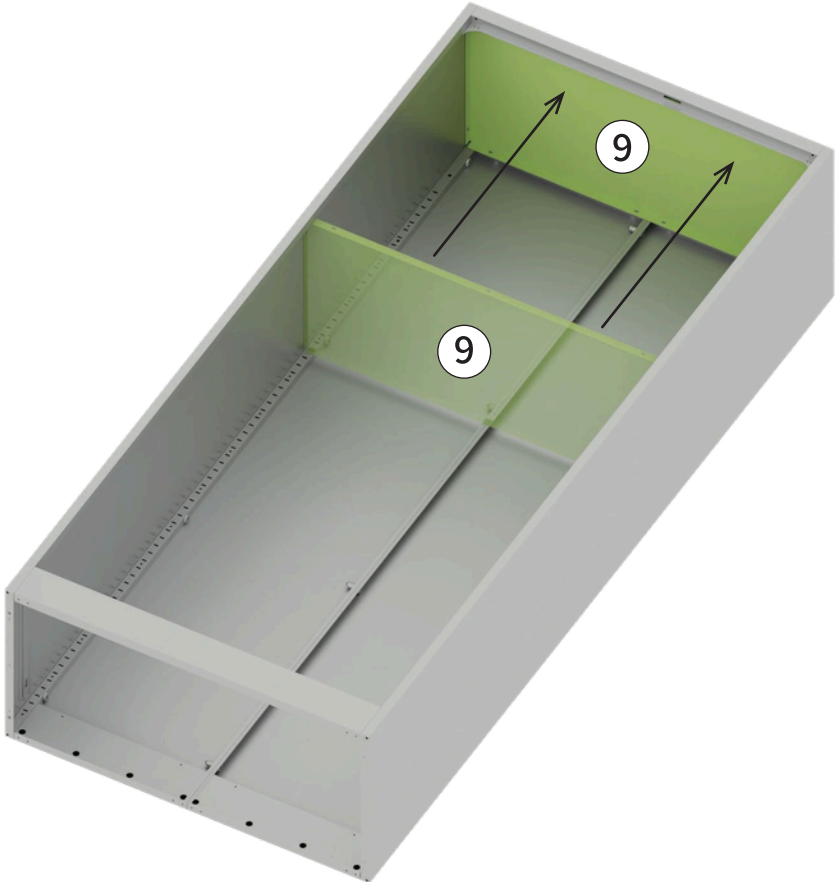
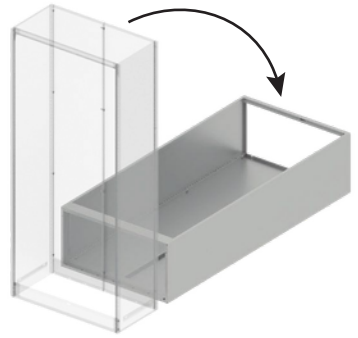

7



(K10)
7x

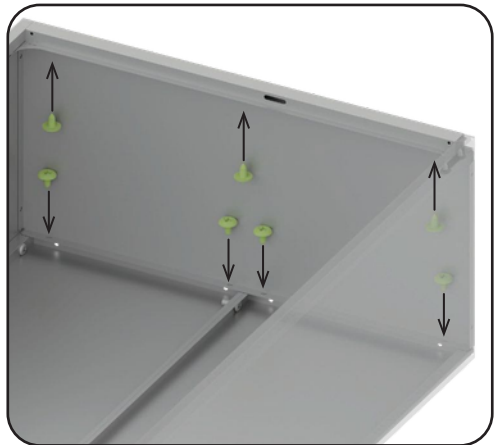

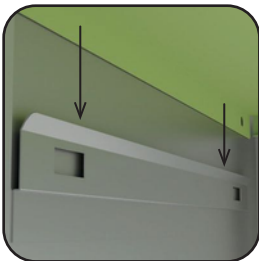
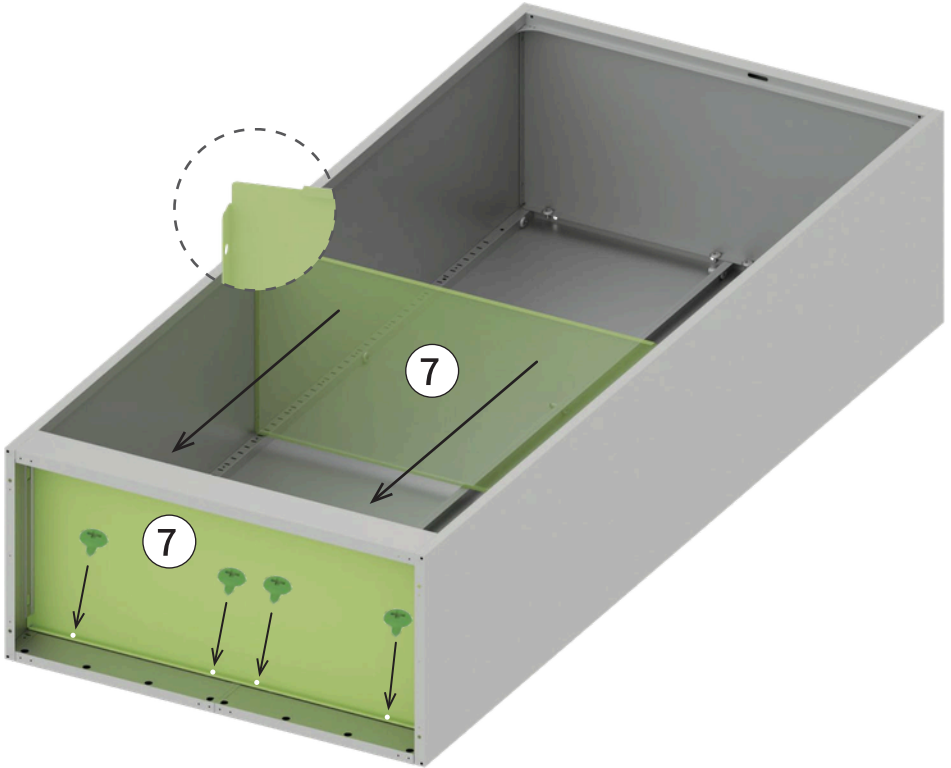

9

Kubin

(L21)

16x

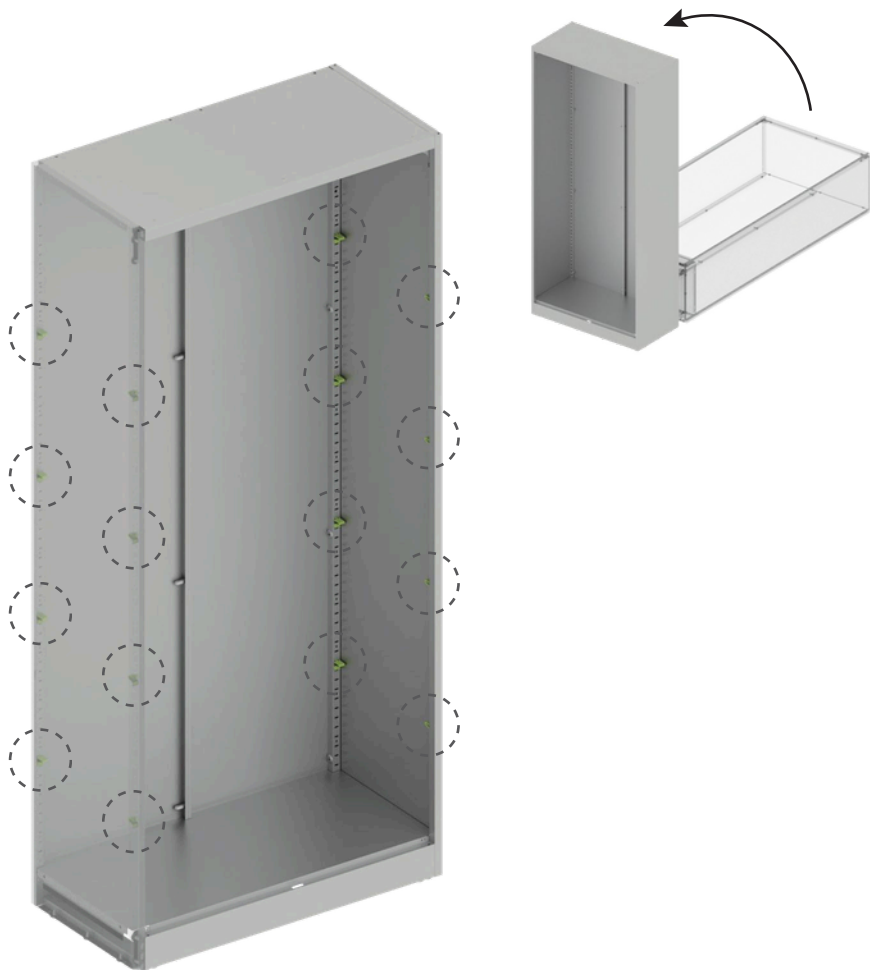

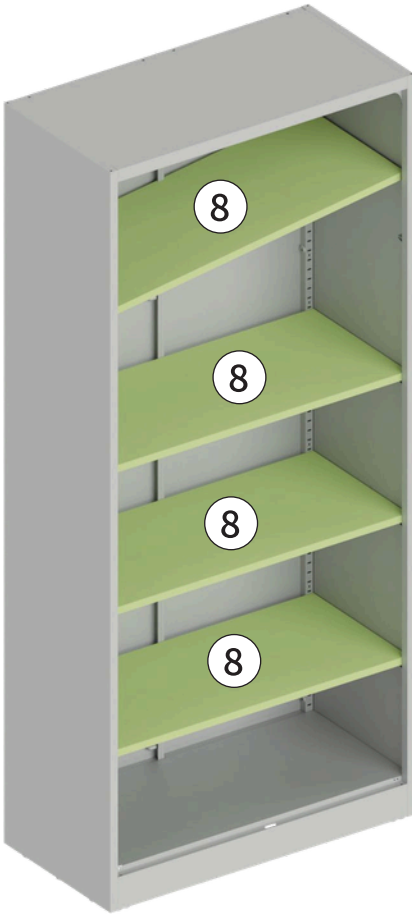

11

Kubin

C14
2x



L19
2x

